

GPS ANTENNA REMOVAL/INSTALLATION

B3E092066936W01

1. Disconnect the negative battery cable.
2. Remove the following parts:
 - (1) Front scuff plate (Passenger's side) (See [FRONT SCUFF PLATE REMOVAL/INSTALLATION.](#))
 - (2) Front side trim (Passenger's side) (See [FRONT SIDE TRIM REMOVAL/INSTALLATION.](#))
 - (3) Decoration panel (See [DECORATION PANEL REMOVAL/INSTALLATION.](#))
 - (4) Glove compartment (See [GLOVE COMPARTMENT REMOVAL/INSTALLATION.](#))
 - (5) Car-navigation unit (See [CAR-NAVIGATION UNIT REMOVAL/INSTALLATION.](#))
 - (6) Passenger junction box (PJB) (See [PASSENGER JUNCTION BOX \(PJB\) REMOVAL/INSTALLATION.](#))
3. Remove in the order indicated in the table.

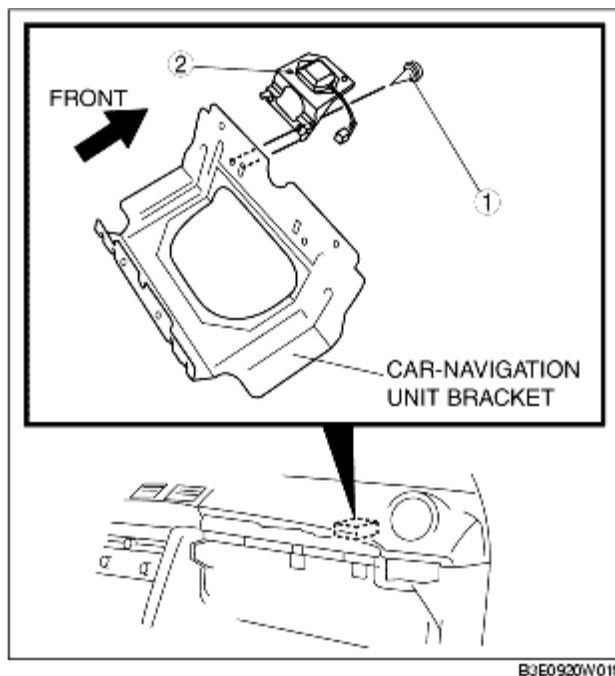

| | |
|---|-------------|
| 1 | Screw |
| 2 | GPS antenna |

4. Install in the reverse order of removal.